



## 66713 CART KIT

[FOR SINGLE POST RAM 651605]

AIR REGULATOR

### DESCRIPTION

The 66713 Cart Kit is intended for use on the Aro 651605 Single Post Ram Ass'y. The holes for mounting wheels and handle are provided in the base ass'y.

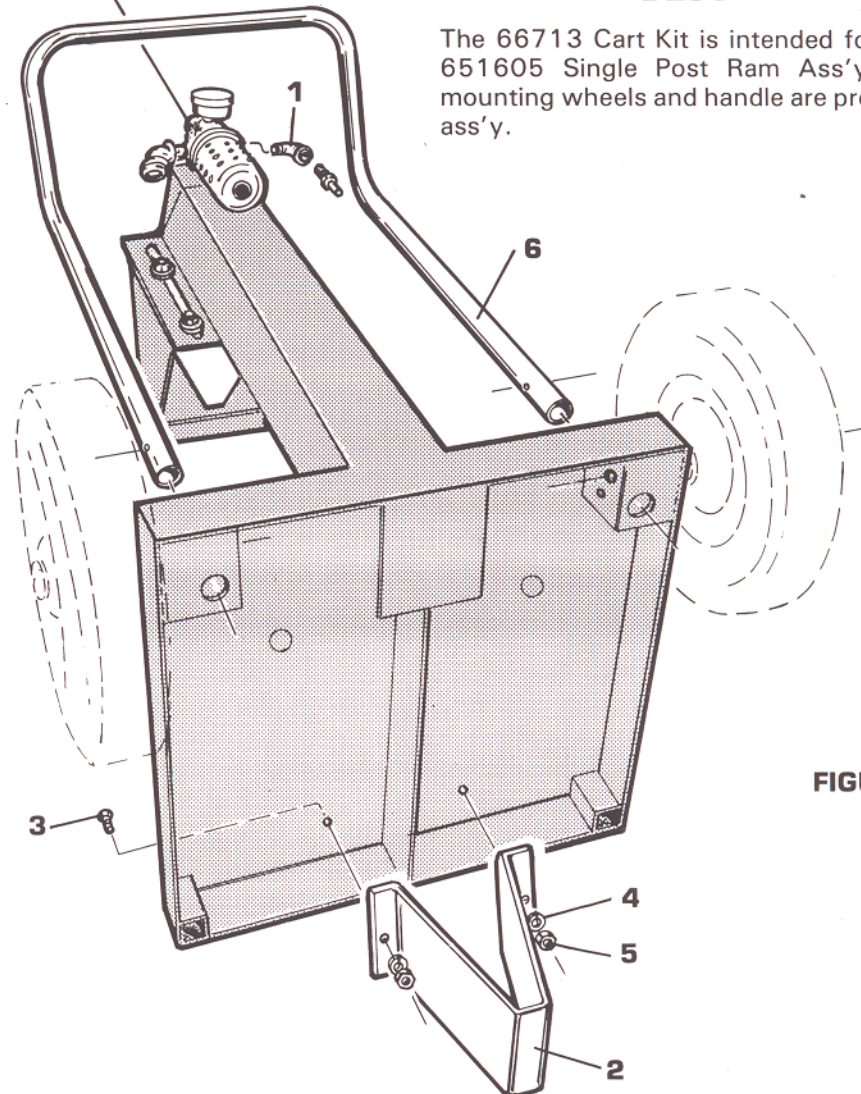

FIGURE 1

### ASSEMBLY

1. Remove inlet connector from air regulator and install **1** street elbow. Reinstall inlet connector into **1**.

**NOTE:** Make sure **1** elbow is installed to keep hose from interfering with **6** handle during lift operation.

2. Remove pump from cart and secure any loose accessories. Tip cart forward so that the underside of cart is exposed (See Fig. 1).
3. Locate **2** base stand as shown and secure with **3** Screw (2), **4** Lockwashers (2), **5** Nuts (2).

**NOTICE:** READ THIS MANUAL CAREFULLY BEFORE OPERATING, INSTALLING OR SERVICING THIS EQUIPMENT.

**THE ARO CORPORATION**

ONE ARO CENTER, BRYAN, OHIO 43506  
PHONE - 419-636-4242

PRINTED IN USA



**FIGURE 2**

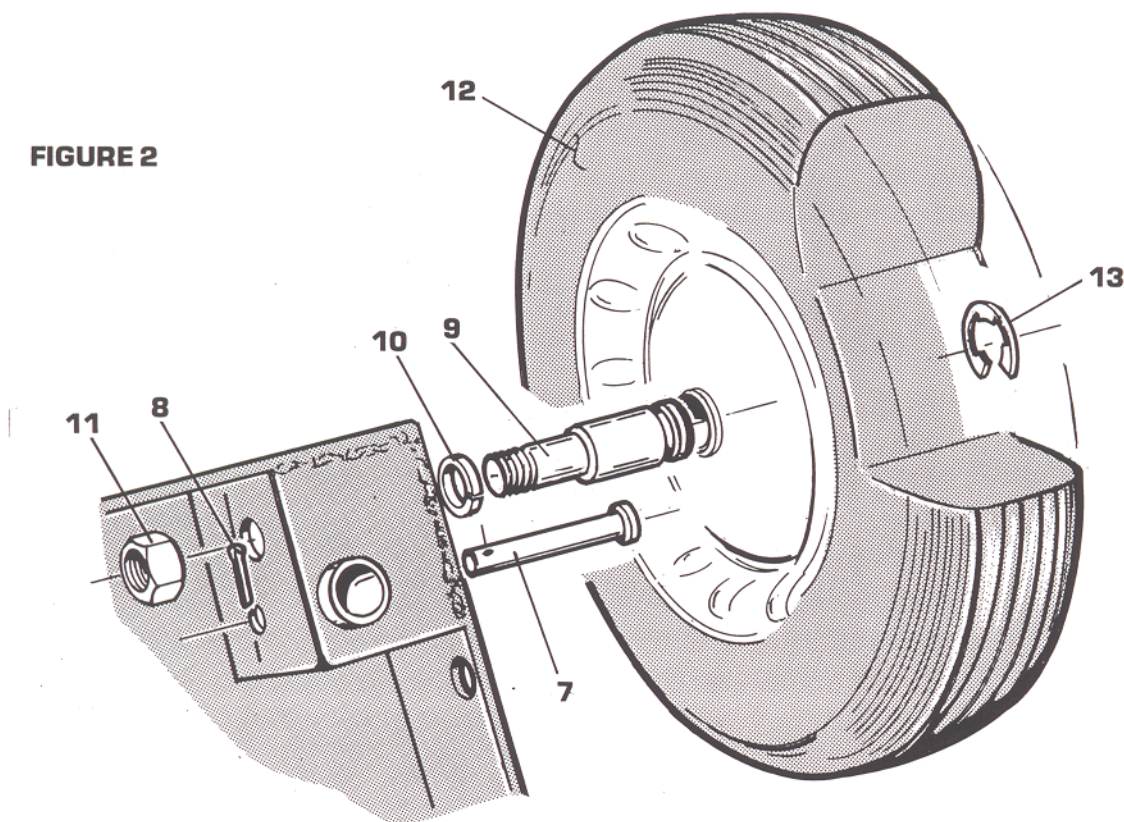

4. Locate handle on cart and allow installation of **7** retaining pin (as shown) and retain this assembly with **8** cotter pin.
5. Insert threaded end of **9** axle (2) thru **10** washer (2) and into base as shown. Secure with **11** nut (2).
6. Place **12** wheels (2) on **9** axle (2) and secure with **13** retaining ring (2).

### PARTS LIST

REF.	QTY.	PART NO.	DESCRIPTION
<b>1</b>	1	Y43-4-C	STREET ELBOW
<b>2</b>	1	90418-1	BASE STAND
<b>3</b>	2	Y8-58-C	SLOTTED ROUND HEAD SCREW 5/16" - 18
<b>4</b>	2	Y14-516-C	LOCK WASHER 5/16"
<b>5</b>	2	Y12-5-C	NUT 5/16" - 18
<b>6</b>	1	75824	HANDLE
<b>7</b>	2	75834	RETAINING PIN
<b>8</b>	2	Y15-31-C	COTTER PIN 3/32" x 1/2"
<b>9</b>	2	98873	AXLE
<b>10</b>	2	Y14-625	LOCK WASHER 5/8"
<b>11</b>	2	Y11-10-C	NUT 5/8" - 18
<b>12</b>	2	75823	WHEEL
<b>13</b>	2	90102	RETAINING RING